

Name	Signatur	Datum	Artikelnummer	Oberfläche: Geschliffen Korn 240
Ch. Höfig	CH	27.11.2019	59112-240	
Werkstoff:				Blattformat
1.4301 (X5CrNi18-10)				A4
Gewicht 0.854 kg		Massstab: 1:2.5	Version:	Blatt 1 von 4

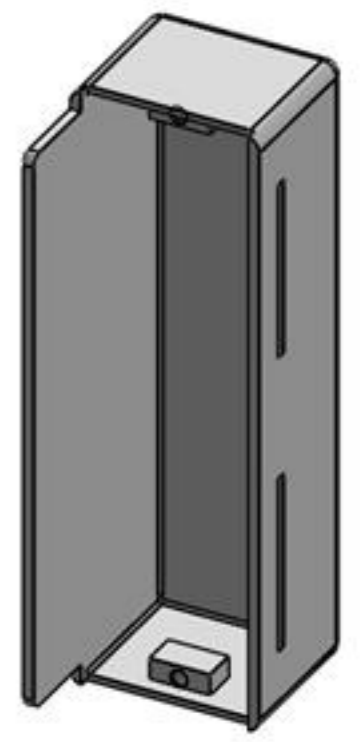

Name	Signatur	Datum	Artikelnummer	Oberfläche: Geschliffen Korn 240
Ch. Höfig	CH	27.11.2019	59112-240 Teil1	
Werkstoff:				Blattformat
1.4301 (X5CrNi18-10)				A4
Gewicht 0.707 kg		Maßstab: 1:2.5	Version:	Blatt 2 von 4

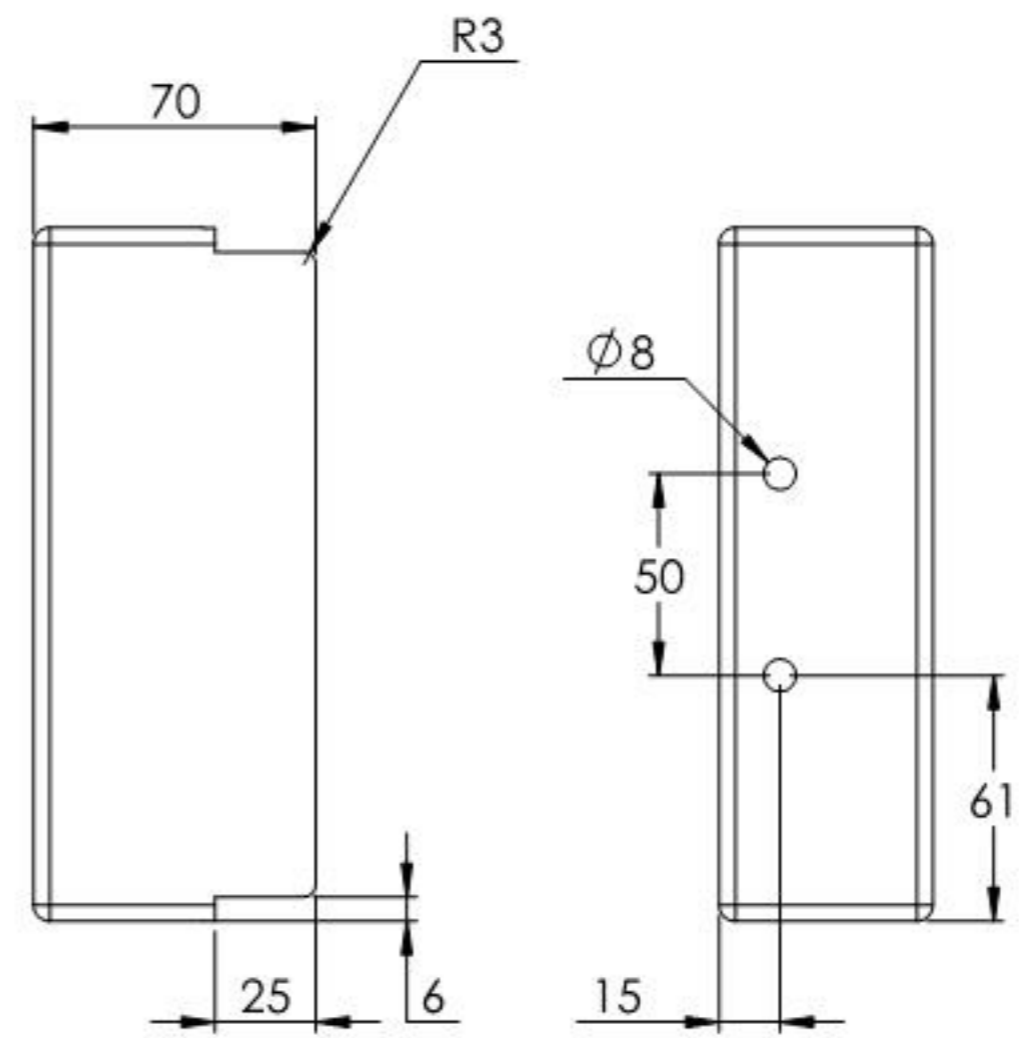
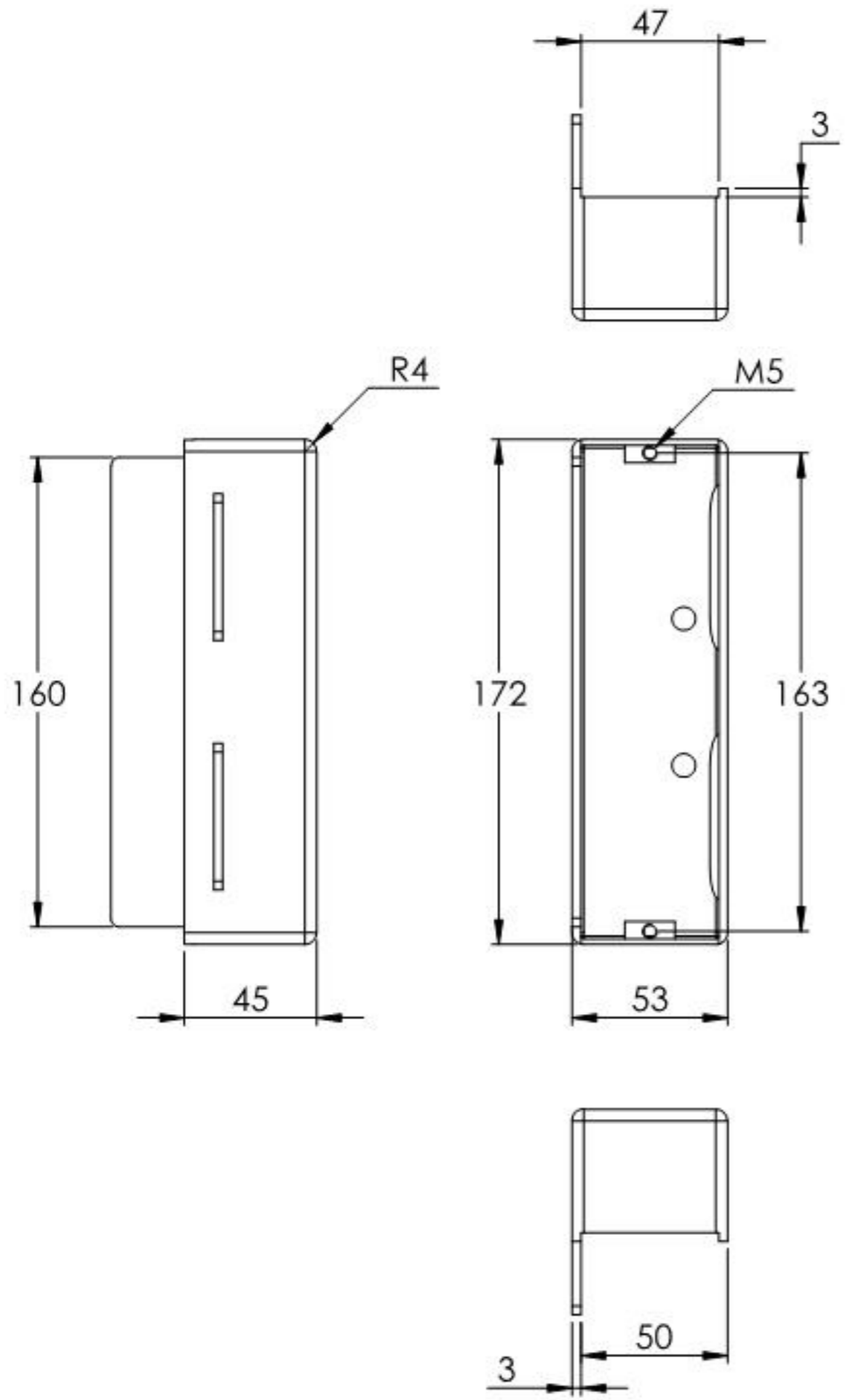
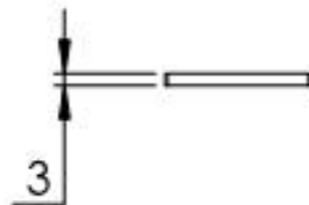
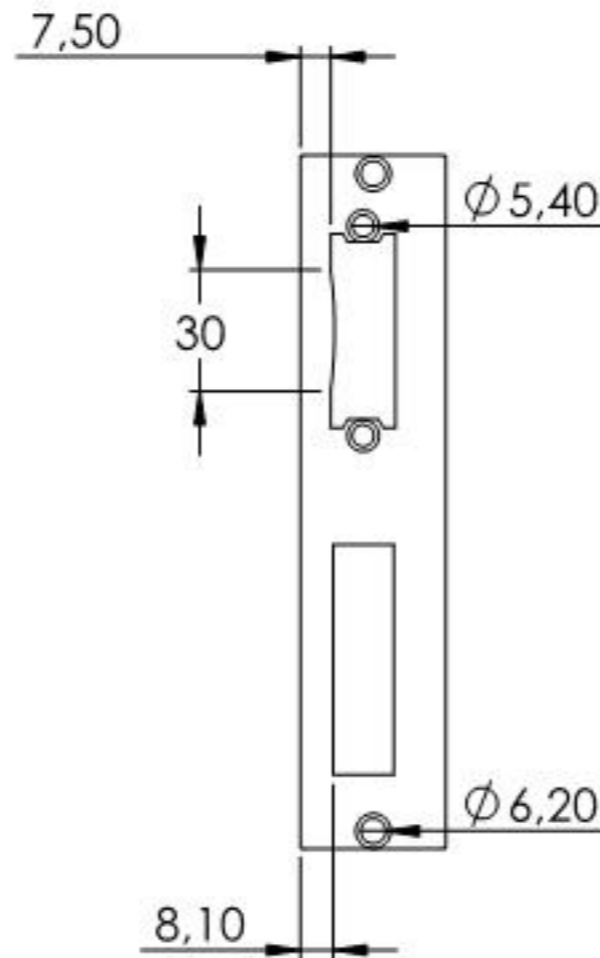
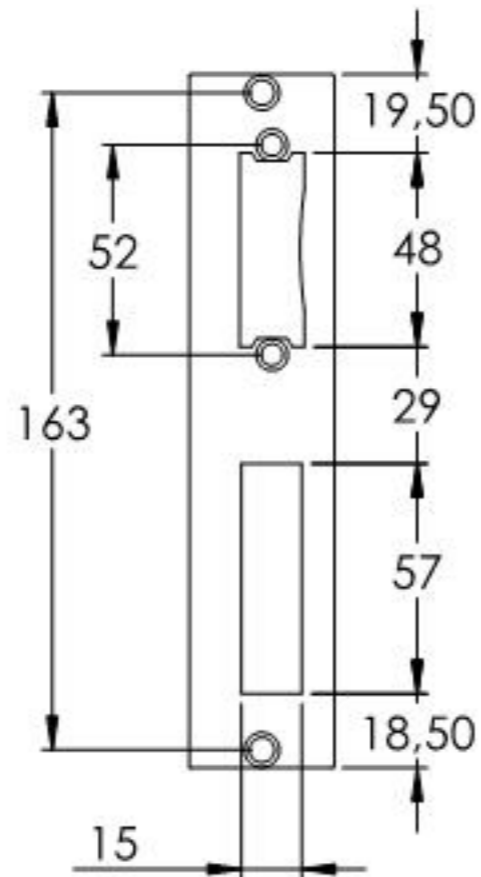
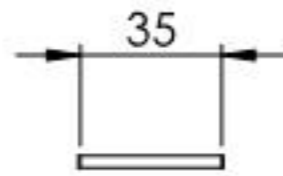

Name	Signatur	Datum	Artikelnummer	Oberfläche: Geschliffen Korn 240
Ch. Höfig	CH	27.11.2019	59110-SB	
Werkstoff:				Blattformat
1.4301 (X5CrNi18-10)				A4
Gewicht 0.106 kg		Maßstab: 1:2,5	Version:	Blatt 3 von 4